

# the floorplan...

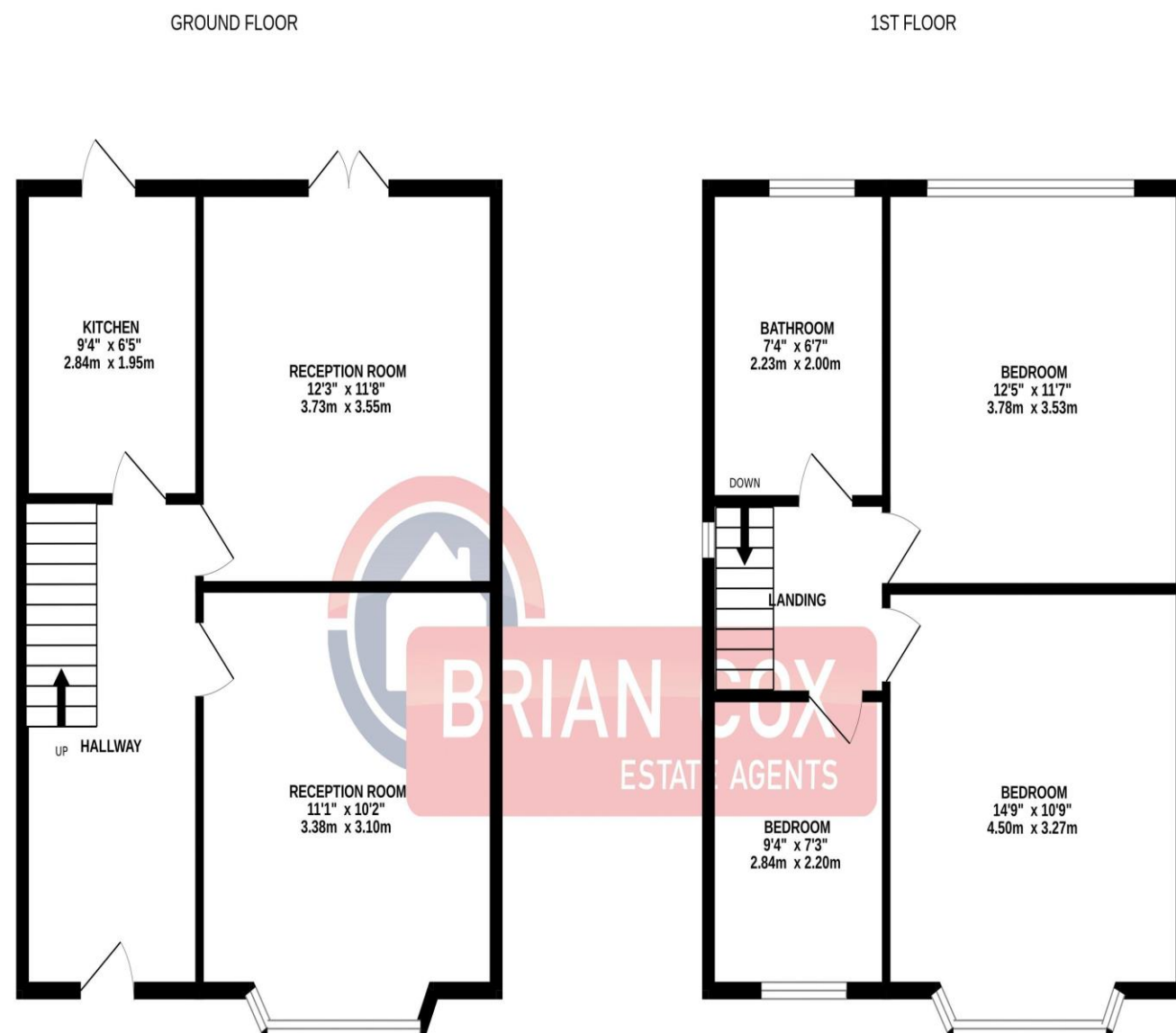

Whilst every attempt has been made to ensure the accuracy of the floorplan contained here, measurements of doors, windows, rooms and any other items are approximate and no responsibility is taken for any error, omission or mis-statement. This plan is for illustrative purposes only and should be used as such by any prospective purchaser. The services, systems and appliances shown have not been tested and no guarantee as to their operability or efficiency can be given.  
Made with Metropix ©2024

## more details from...

**call:** Brian Cox Greenford: 020 8578 1005  
**email:** [bradley.grant@brian-cox.co.uk](mailto:bradley.grant@brian-cox.co.uk)  
**web:** [www.brian-cox.co.uk](http://www.brian-cox.co.uk)



Consumer Protection from Unfair Trading Regulations 2008 We have not tested any apparatus, equipment, fixtures, fittings or services and so cannot verify that they are in working order or fit for purpose. You are advised to obtain verification from your solicitor or surveyor. References to the tenure of a property are based on information supplied by the seller. We have not had sight of the title documents and a buyer is advised to obtain verification from their solicitor. Items shown in photographs are not included unless specifically mentioned within the sales particulars, but may be available by separate negotiation. We advise you to book an appointment to view before embarking on any journey to see a property, and check its availability.



0208 578 1005  
[brian-cox.co.uk](http://brian-cox.co.uk)



Brian Cox and Company are delighted to offer this very well presented three-bedroom home situated on the ever-popular Mansell Road. The property boasts many features including gas central heating and double glazing. Accommodation comprises entrance hallway with doors to both reception rooms, Upstairs there are three bedrooms, fitted bathroom and access to your loft which offers further potential to extend (STPP). Situated within easy walking distance to Greenford Broadway with an array of shops and shopping facilities and transport links makes an early inspection strongly recommended.



Offers Over £525,000  
Freehold

Mansell Road, Greenford UB6 9EH





## in brief...

- Mid-Terraced Freehold House
- Chain Free
- Three Bedrooms
- Gas Central Heating
- Walking distance to Greenford Broadway



## the location...

### nearest stations ...

South Greenford (1.0 miles)  
Greenford (1.1 miles)  
Castle Bar Park (1.1 miles)

Greenford is located within the Ealing borough of London and Zone four of the Central Line tube. It would take roughly 20 minutes to walk to the tube or you have several bus routes which are within a minute walk from the property that will take you directly to Greenford, Northolt, Southall, or Ealing Station.

The A40 is located within a two-minute drive and offers excellent links into London and out to the Home Counties.

Local schools are in abundance with Stanhope, Edward Betham, Costons, Ravenor Park and Allenby Primary schools all within 1 mile of the property. You have a large selection of secondary schools which include, Dormers Wells, Cardinal Wiseman, William Perkins & Greenford High.

020 8578 1005

[brian-cox.co.uk](http://brian-cox.co.uk)